

KeyFFC-300-A1 QBH to D80 Converter

Spec 1007 Rev. A

Features

- Compact
- Proprietary Locking Method of QBH

Applications

- Industrial Laser Processing
- Scientific Research

Specifications

Parameter	Unit	Value
Laser Power	W	≤ 300
Operating Wavelength	nm	1080 ± 10
Input Beam Numerical Aperture (NA)	-	≤ 0.11
Coupling Efficiency	%	≥ 99
Input Fiber Core Diameter	μm	≤ 50
Input Compatible Interface	-	QBH
Output Fiber Numerical Aperture (NA)	-	0.22
Output Fiber Core Diameter	μm	≥ 600
Output Compatible Interface	-	D80
Weight	kg	≤ 0.50
Operating Temperature	°C	0 ~ 45
Storage Temperature	°C	-20 ~ 70

Dimensions

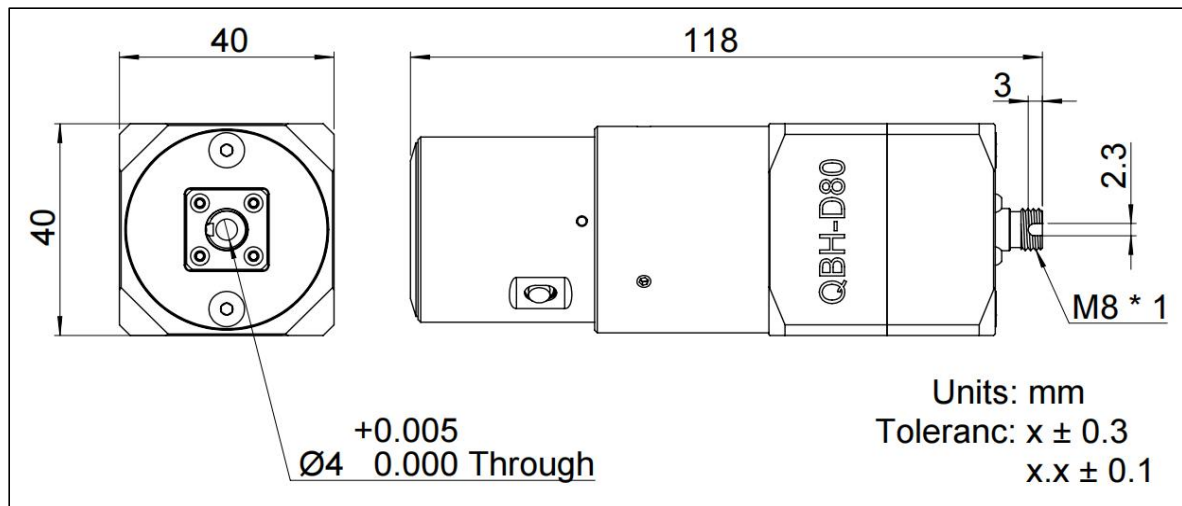

Ordering Information

KeyFFC-300-A1